

TYPES OF PORTABLE FIRE EXTINGUISHER

Three types of commonly used Portable fire extinguishers :

- AFFF compound (water based)
- Dry Chemical Powder (MAP powder)
- CO₂

TYPES OF PORTABLE FIRE EXTINGUISHER



FIRE SAFETY

Anatomy of a Fire Extinguisher

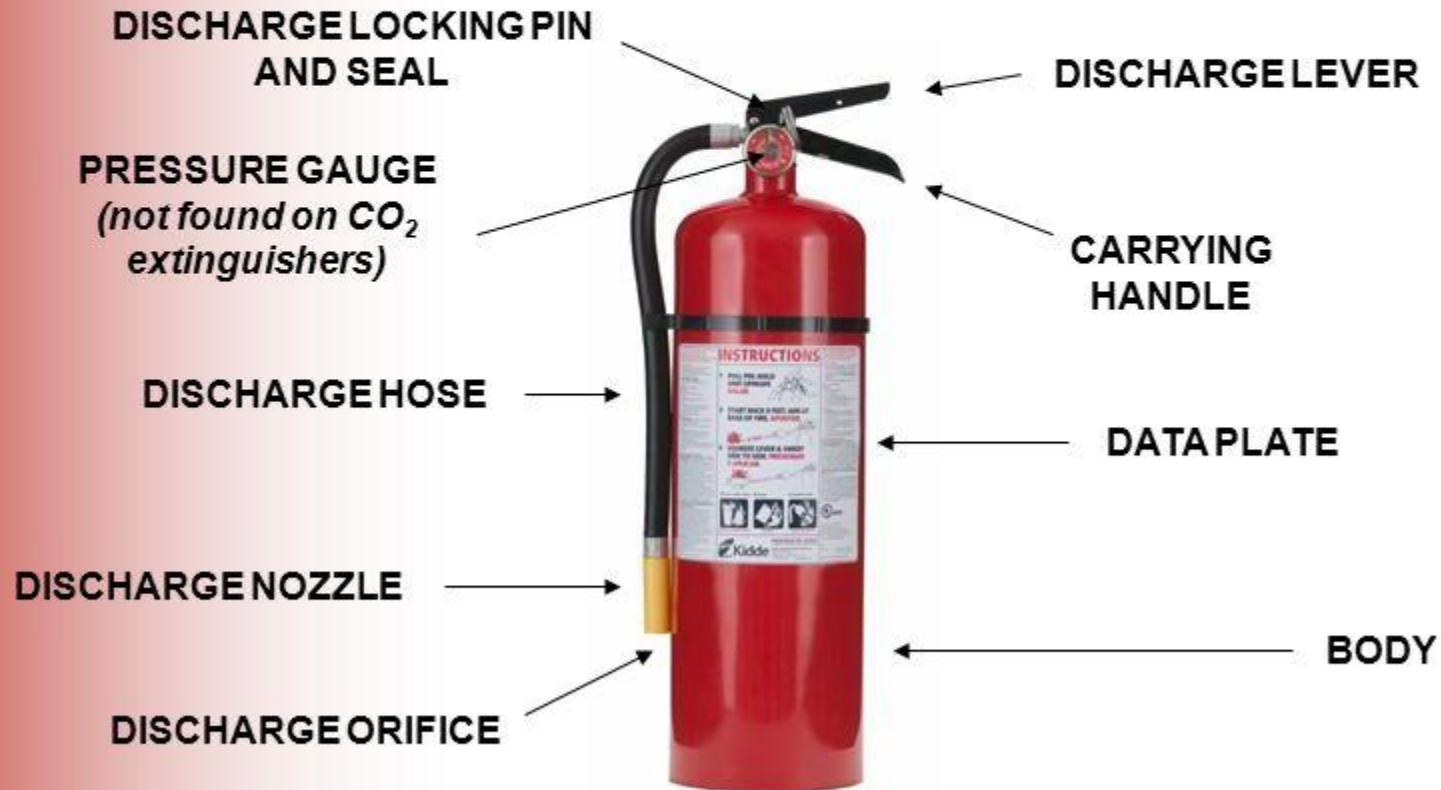

Anatomy of Fire Extinguishers

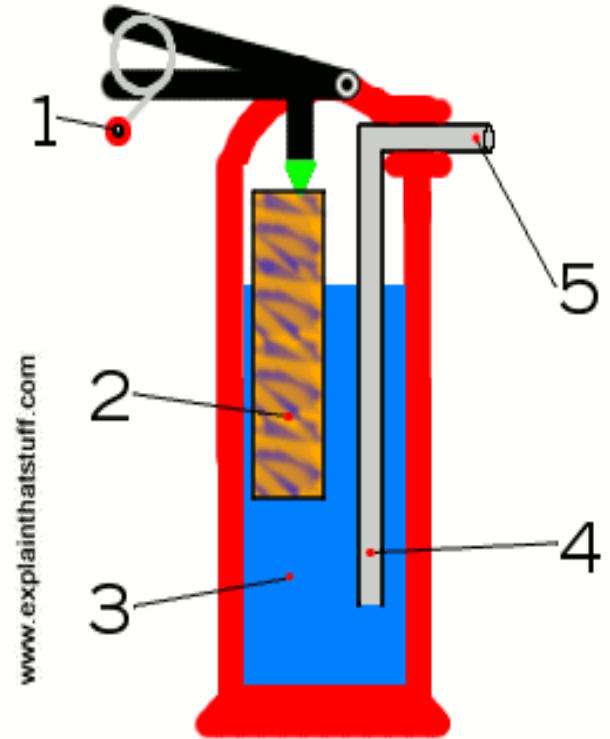



HOW TO USE PORTABLE FIRE EXTINGUISHERS

IF YOU FIGHT A FIRE, REMEMBER THE WORD P A S S PULL . . . AIM . . . SQUEEZE . . . SWEEP

To operate an extinguisher:

Pull

Aim

Squeeze

Sweep

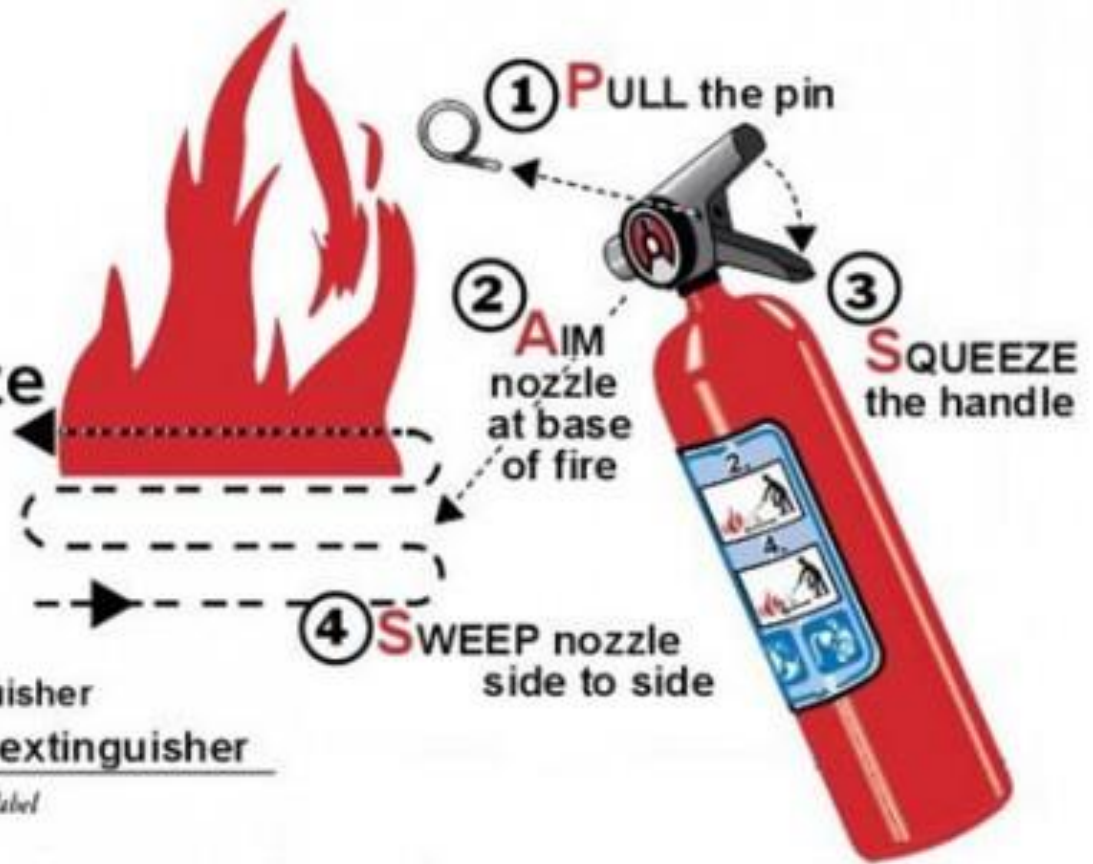

Know your extinguisher
Use the correct extinguisher

*(Check your own extinguisher's label
for detailed instructions.)*



COMMON SAFETY GUIDELINES AT LABS

- Use personal protective equipment.
- Chemicals received must be checked to ensure that the containers are in good condition.
- Details of new chemicals must be entered in the laboratory inventory and stored in a designated area.
- Bulk stocks must be stored in a separate building.
- Chemicals must not be placed indiscriminately in the storage shelf. They must be grouped based on their compatibility.

- 
- In the event of an accidental breakage or seismic activity, incompatible chemicals that are stored in close proximity can mix to start a fire, hazardous fumes or explosions.
 - Ensure eye washer and Safety Shower are operational.
 - Ensure proper ventilation of the working area.
 - Do not work alone in the laboratories particularly when performing hazardous procedures.
 - Do not perform unauthorized Experiments.
 - Know Emergency Escape routes of the Building.
 - Know operation of Portable Fire extinguisher and their location.